



**DETAILS OF INSTITUTIONAL PLOTS AVAILABLE FOR E-AUCTION**

# LIST OF INSTITUTIONAL PLOTS AVAILABLE



Sr.	Plot Number	Area of Plot (sqm)	Use of Plot	Sector
1	NS-75A	1200	Nursery School	Omicron-3
2	NS-57	841.30	Nursery School	Pi-02
3	NS-87	2063.80	Nursery School	Mu
4	HS-39	16027.75	Higher Secondary School	Omicron-3
5	HS-04	11425.00	Higher Secondary School	Sector-3
6	HS-02	8000.00	Higher Secondary School	Sector-12
7	HS-01	12000.00	Higher Secondary School	Sector-12
8	HO-01	4400.00	Hospital	Sector-2
9	HO-02	10005.00	Hospital	Mu
10	202	332000.00	University	KP-5
11	132	1001.25	Vocational Institute	KP-5
12	89	2001.00	Vocational Institute	KP-5
13	12	114200.00	University	Techzone-2
14	17/2	29767.00	hospital cum Medical Institute	KP-3
15	47	24224.16	Hospital	KP-5
16	33A	20240.00	Hospital	KP-5
17	27E	2616.00	Vocational Institute	KP-3
18	25	4000.00	Vocational/ educational Institute	Techzone-4
19	17	4000.39	Training centre/ Educational Institute	Techzone-4
20	18	4000.39	Training centre/ Educational Institute	Techzone-4
21	22/3	6991.20	Vocational Institute	KP-2
22	NH-01	3660.00	Nursing Home	Sector-1



# PLOT NO – NS-75A, Omicron-3 1,200 sqm

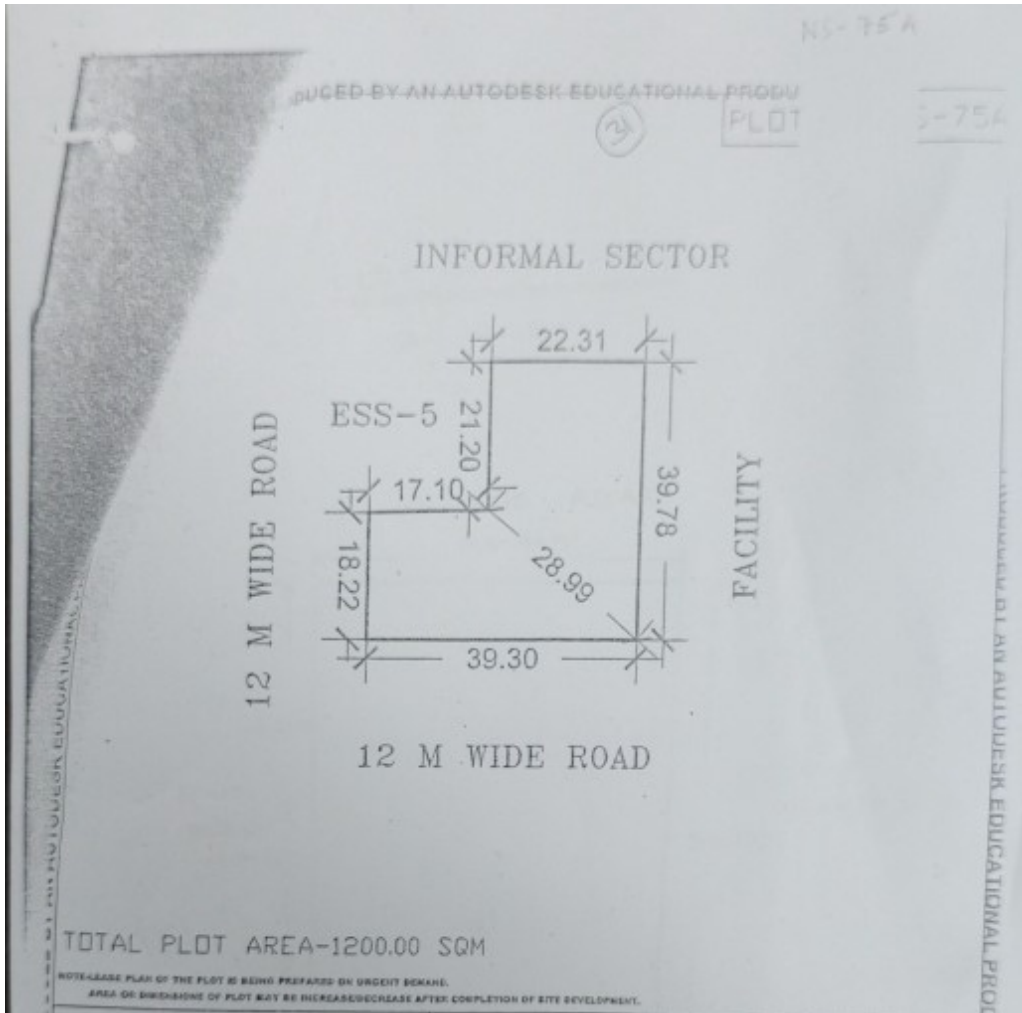

137, Pocket C, Block C, Omicron III, Greater  
Noida, Uttar Pradesh 203207, India

Latitude

28.477123333333333

Longitude

77.554835°

Altitude 211 meters

Monday, 20.03.2023

Local 01:46:37 PM

GMT 08:16:37 AM



# PLOT NO – NS-57, Pi-2

841.30 sq.m.

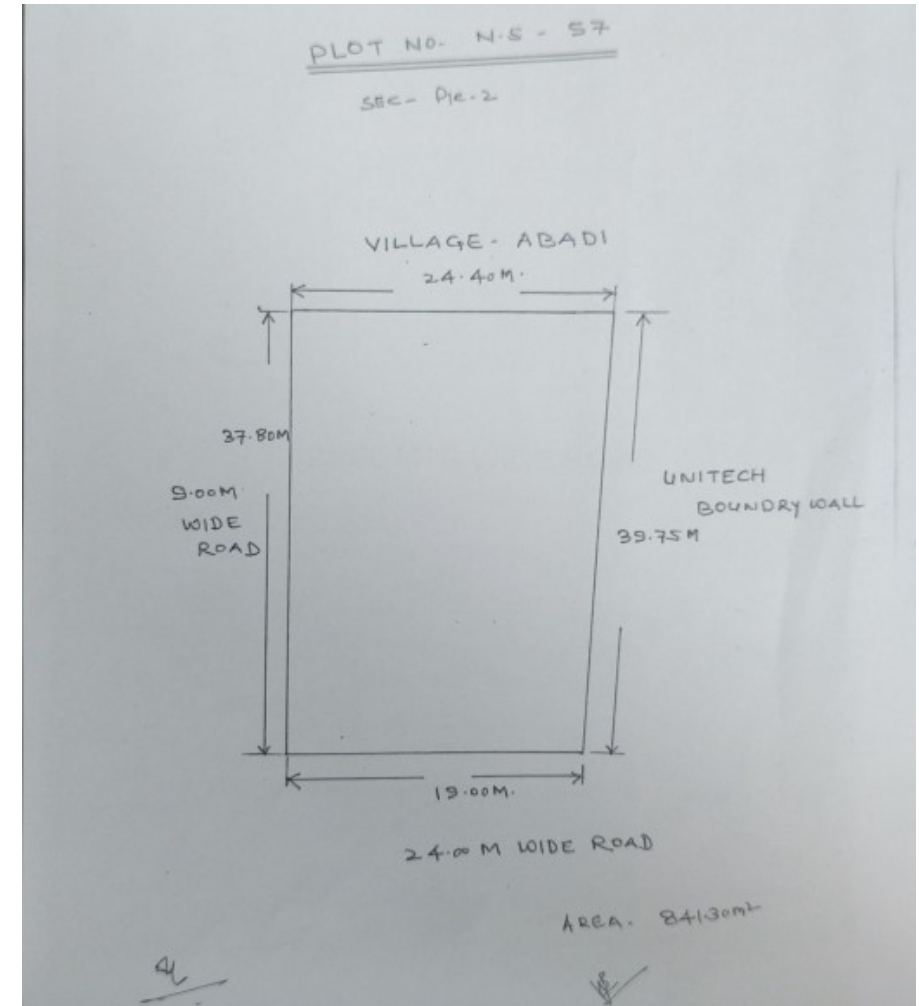
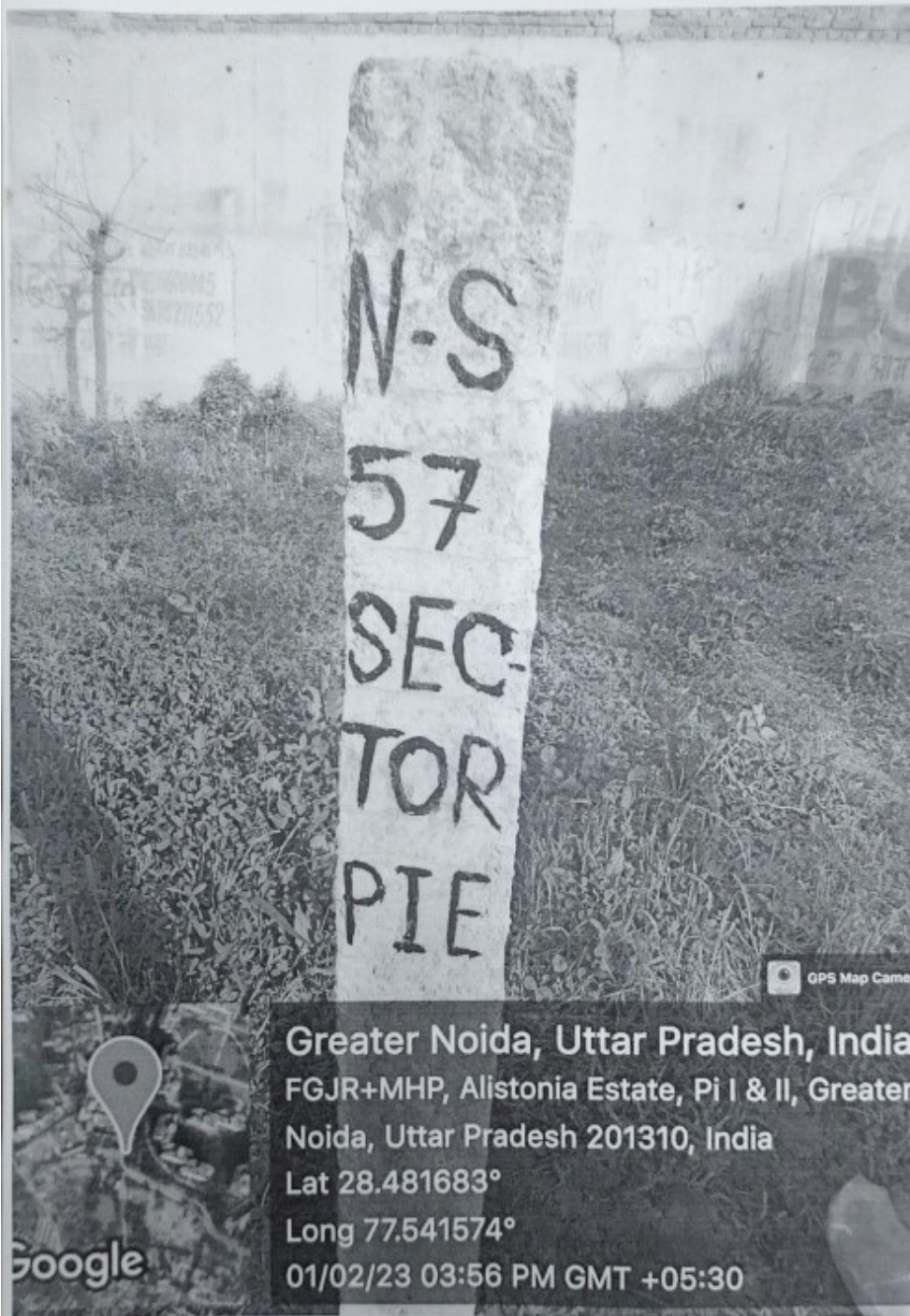



# PLOT NO – NS-87, Mu

2063.80 Sq.m.

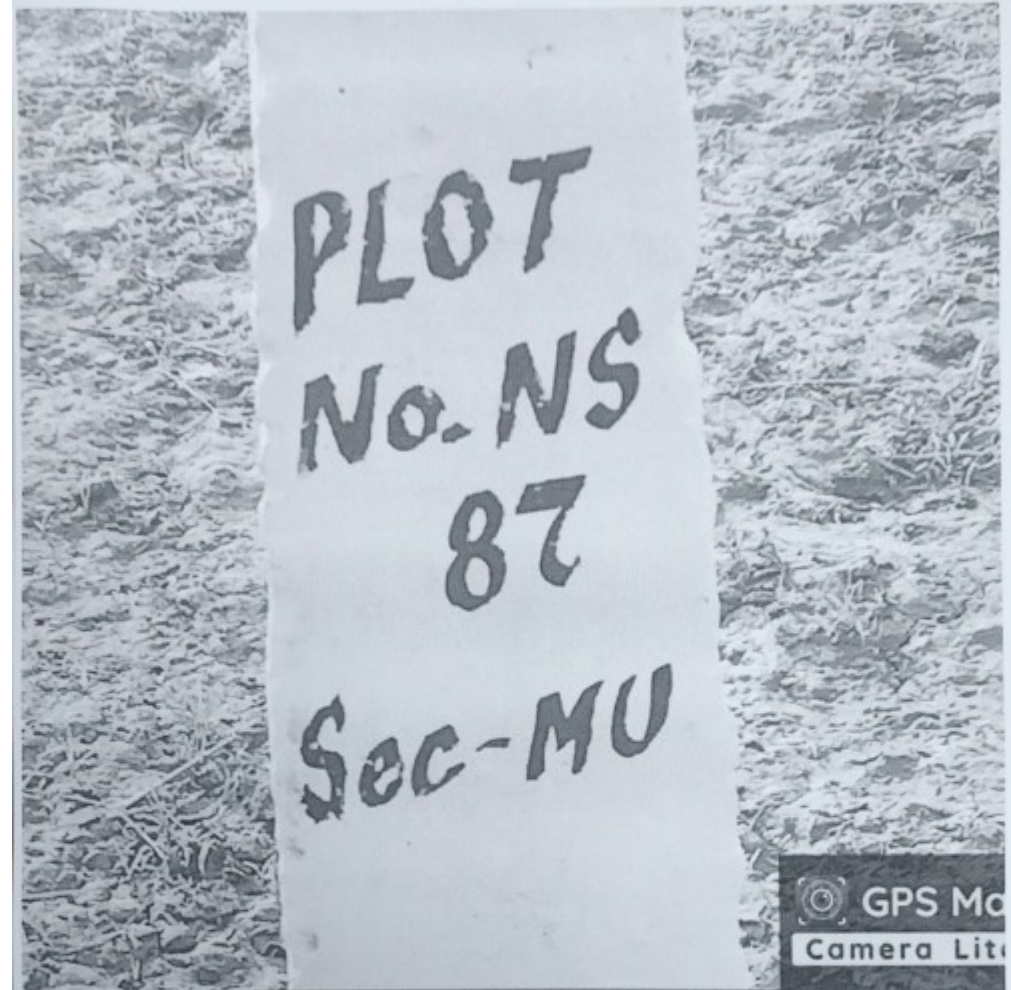
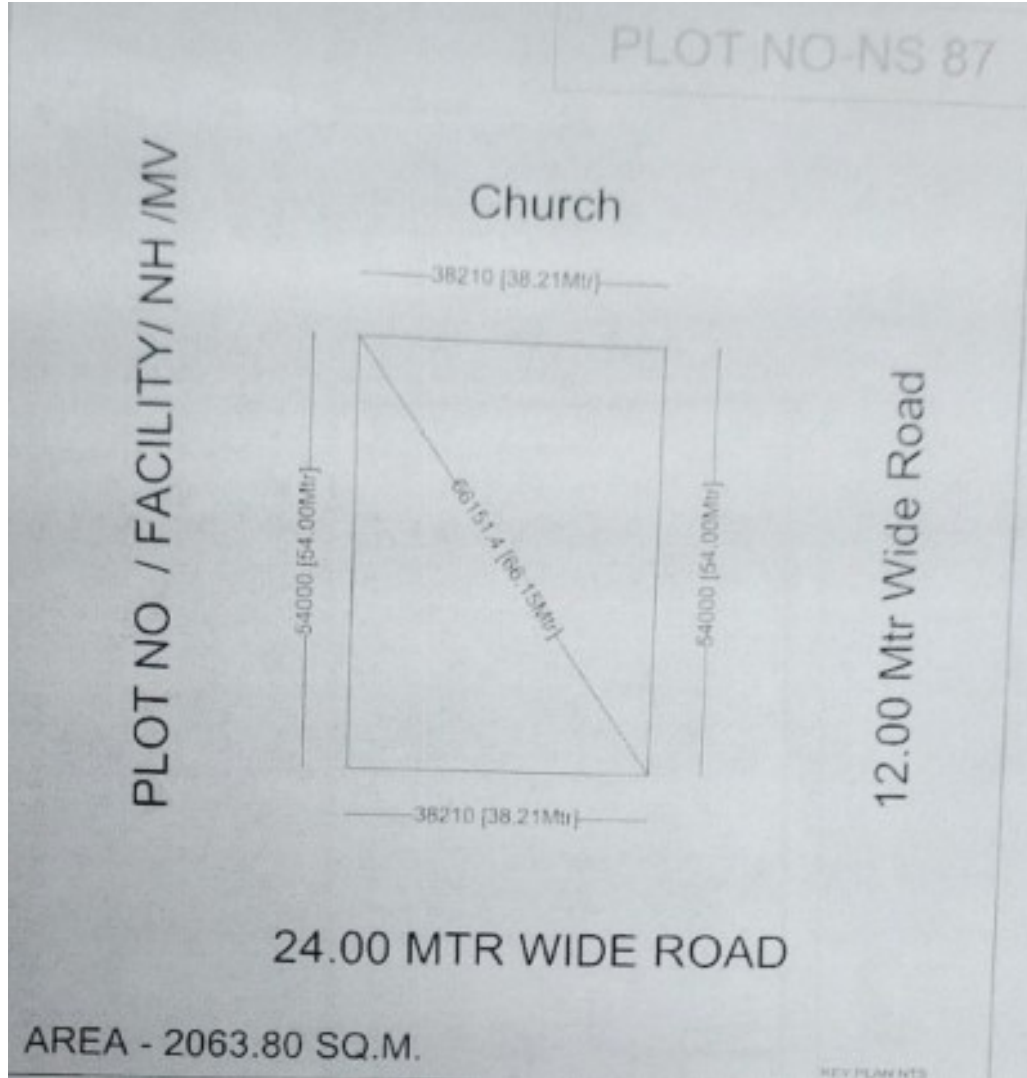

1, Block B, Sector MU 1, Greater Noida, Uttar Pradesh 203207, India

Latitude  
28.476945°

Longitude  
77.56554°

Local 03:33:02 PM  
GMT 10:03:02 AM

Altitude 13.29 meters  
Wednesday, 21.12.2022



# PLOT NO – HS-39, Omicron-3 16027.75 sq.m.

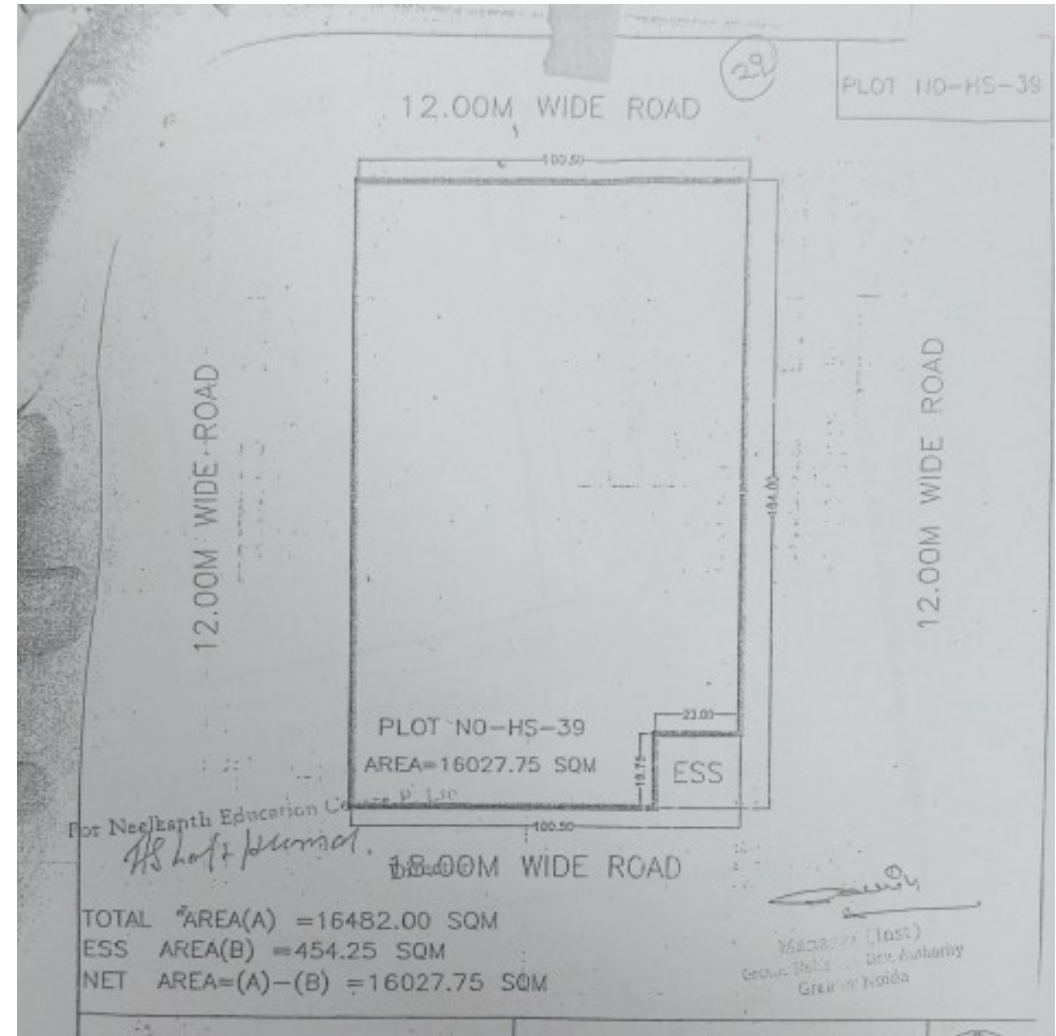
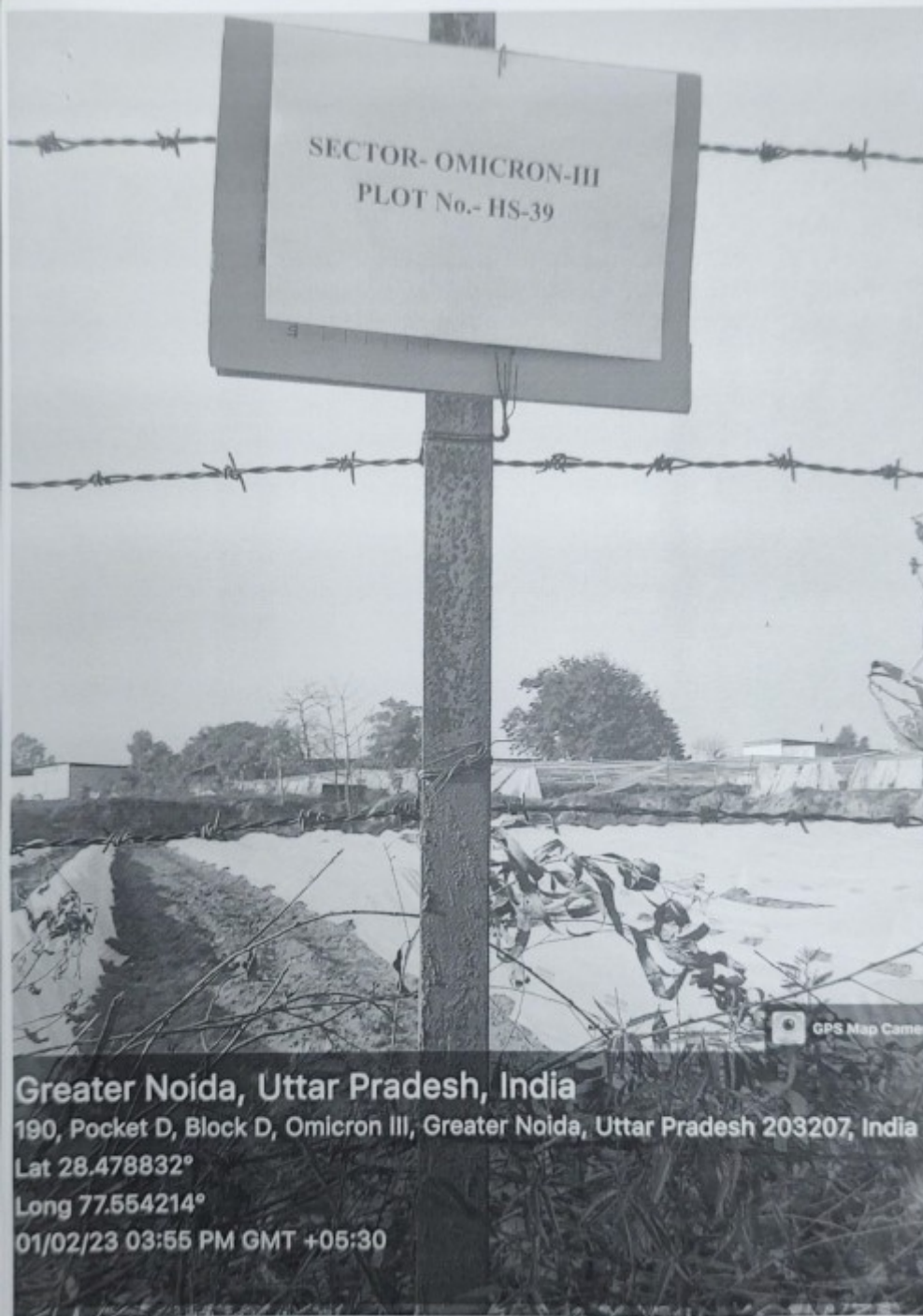



# PLOT NO – HS-04, Sector-3 11425.00 sq.m.

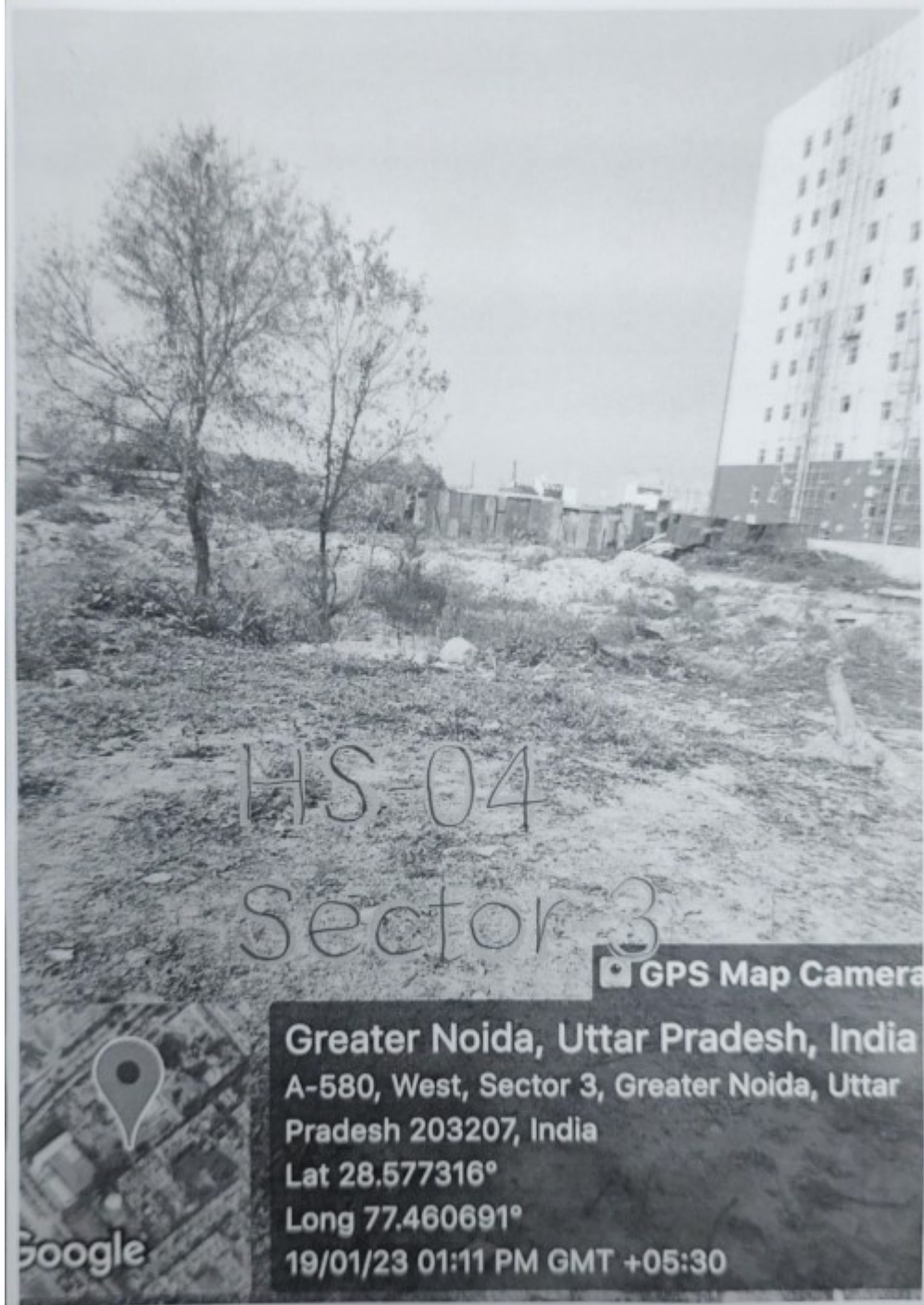
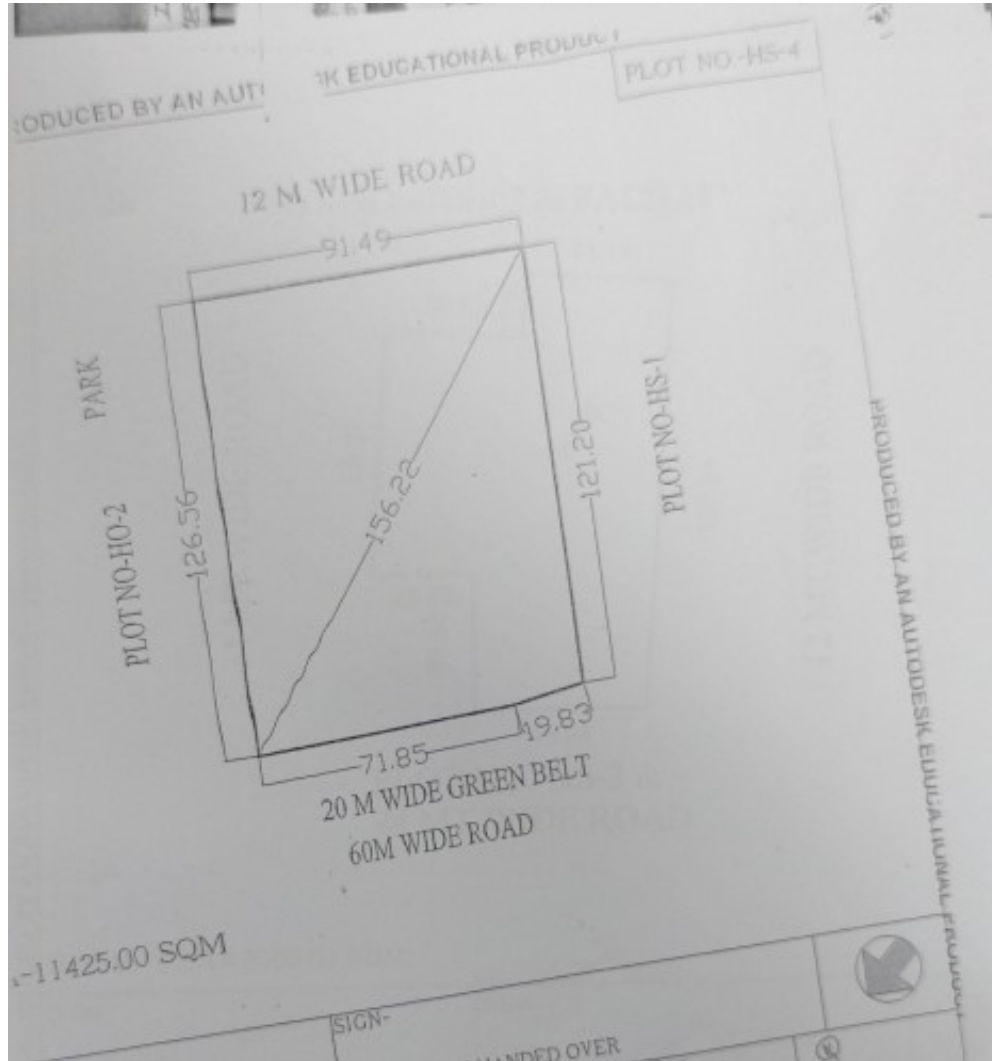



# PLOT NO – HS-02, Sector-12 8,000 sq.m.



GPS Map Camera

Greater Noida, Uttar Pradesh, India  
HF8M+X2C Saini Village Pond, Saini, Greater Noida, Uttar Pradesh 203207, India  
Lat 28.566599°  
Long 77.482282°  
04/02/23 05:27 PM GMT +05:30

Google

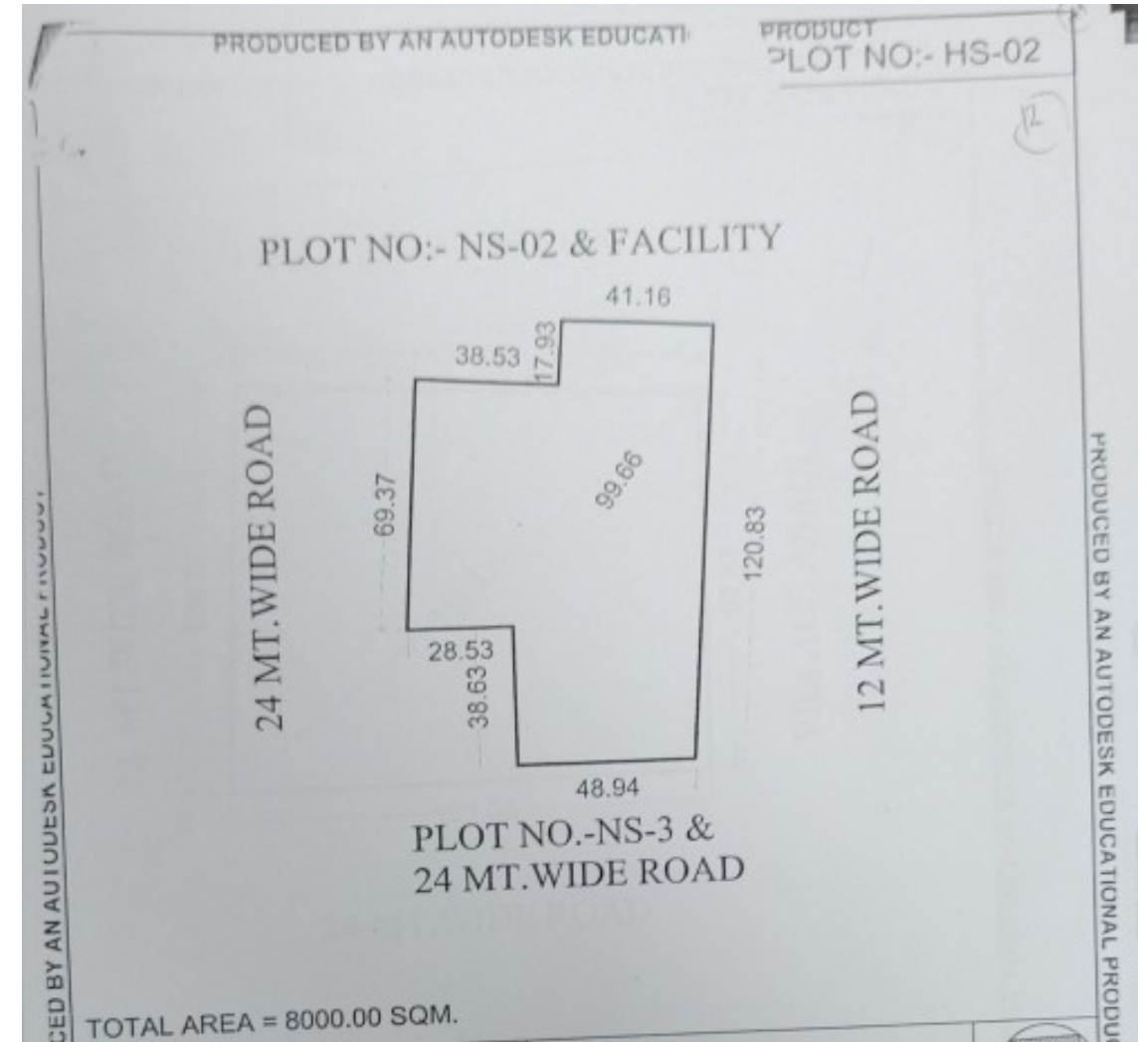





# PLOT NO – HS-01, Sector-12

12,000 sq.m.

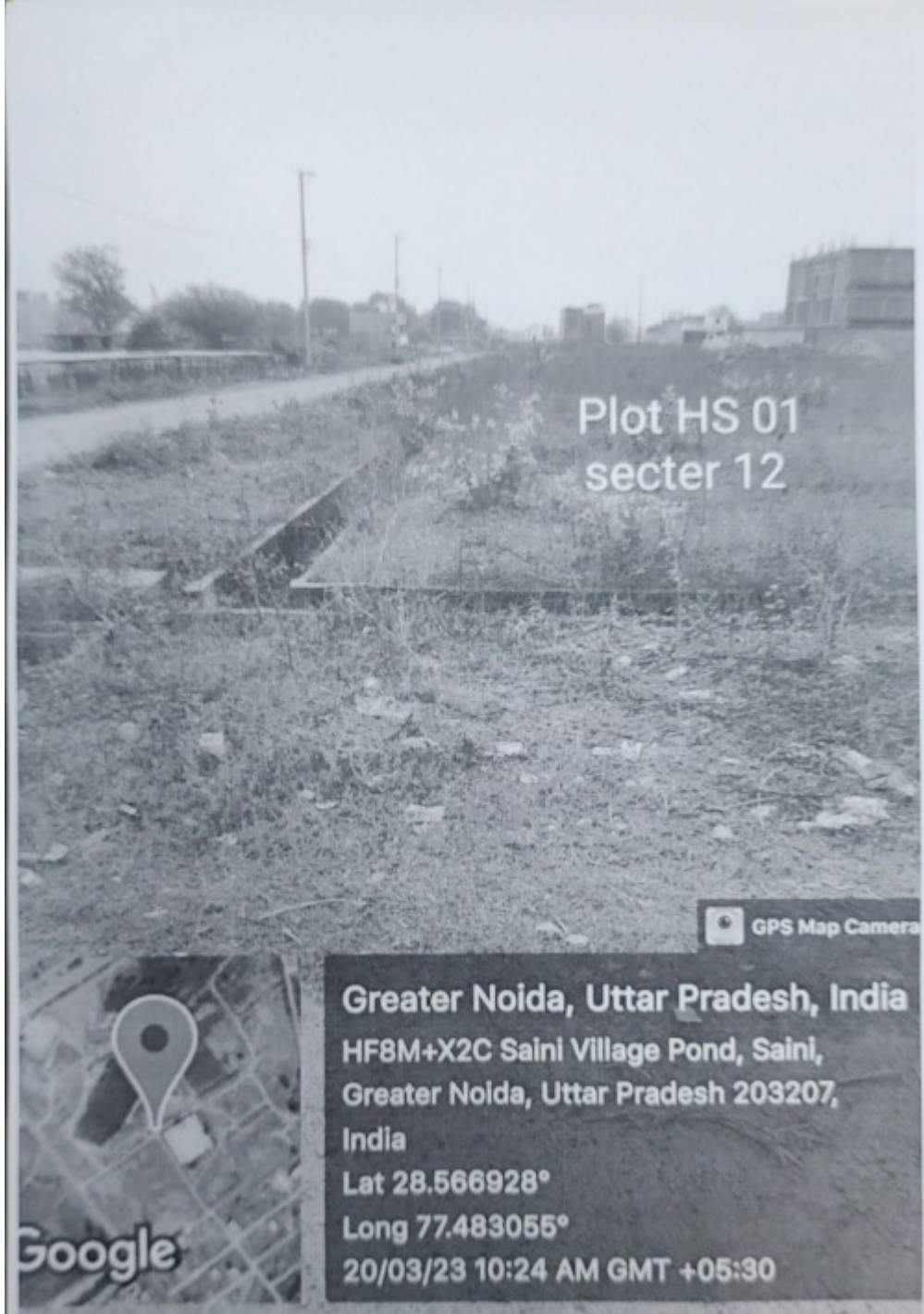
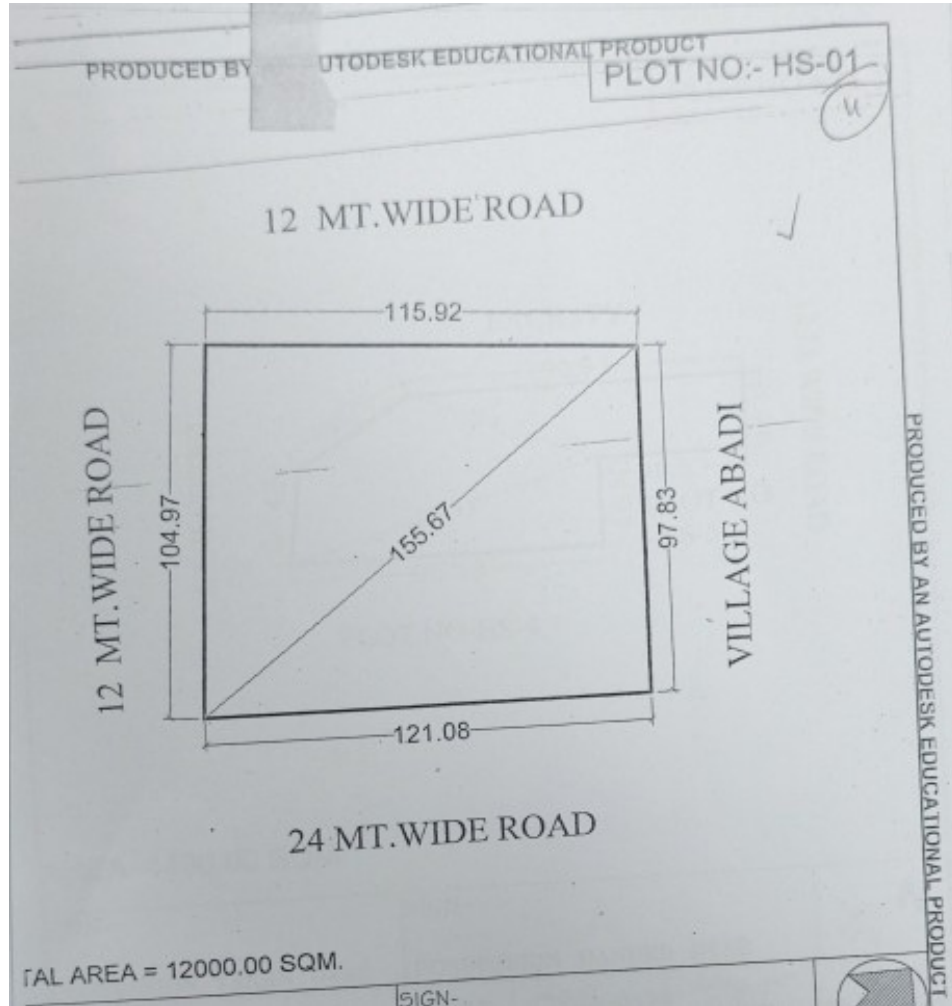



# PLOT NO – HO-01, Sector-2 4,400 sq.m.

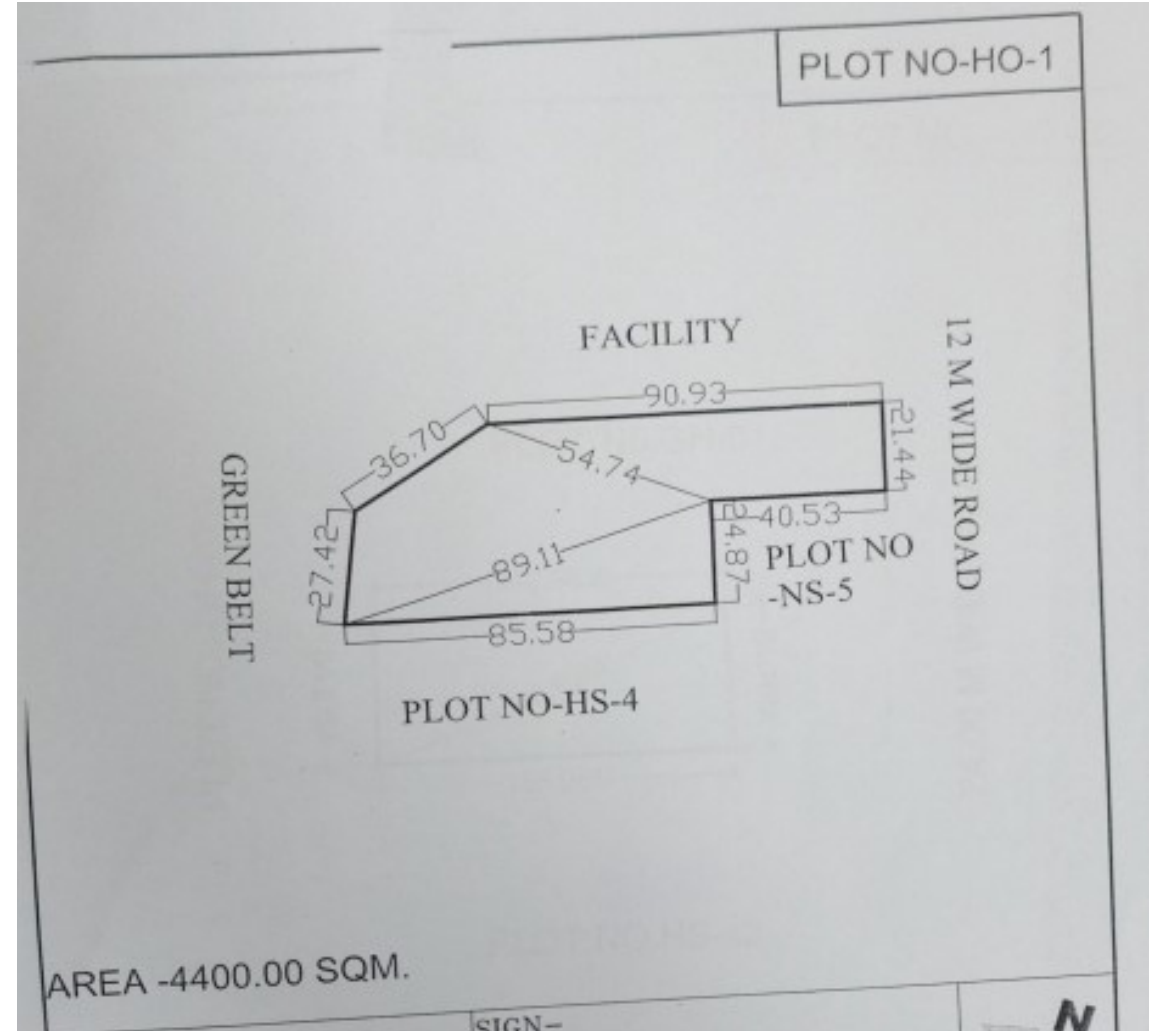
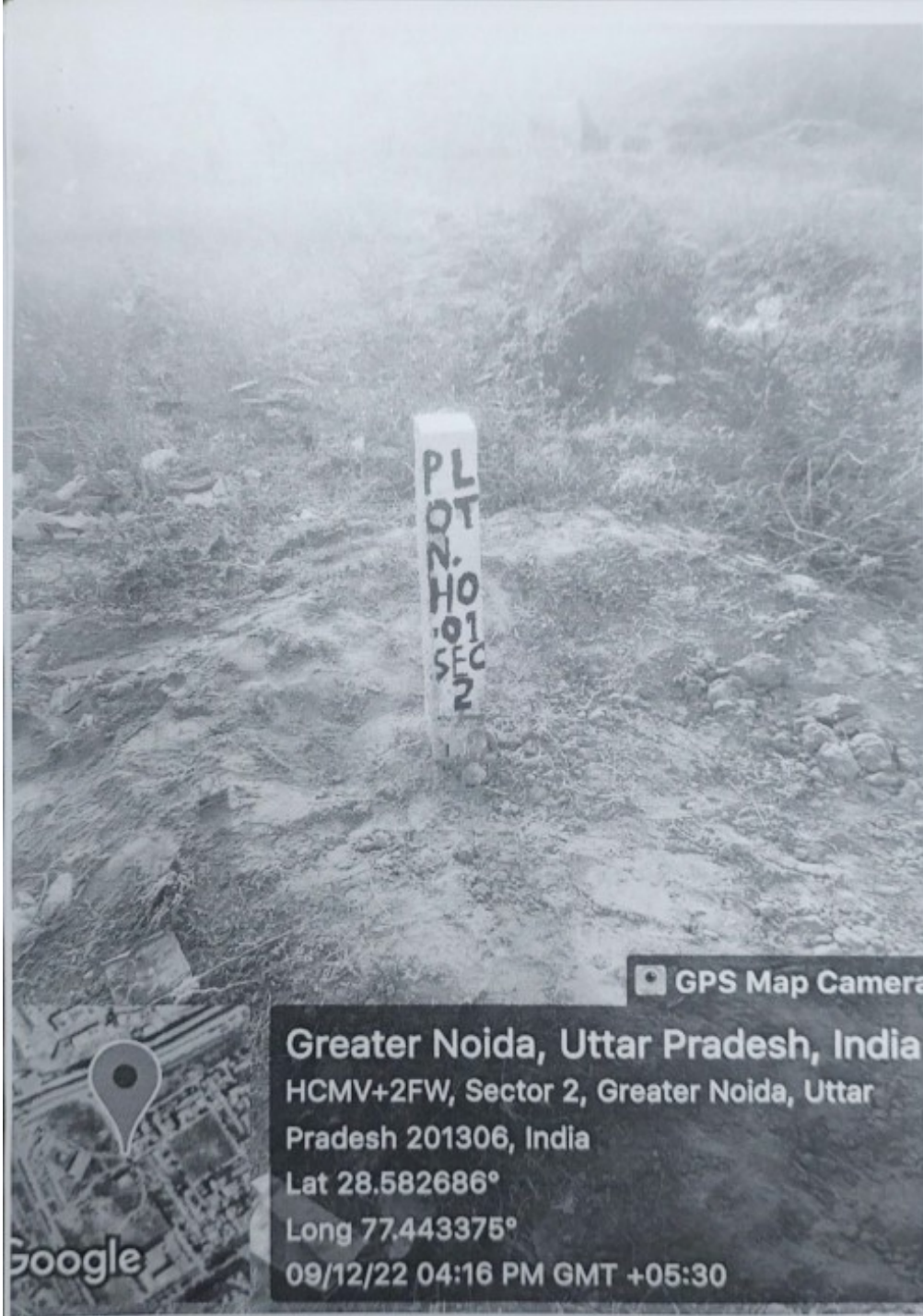



# PLOT NO – HO-02, Mu

10,005 sq.m.

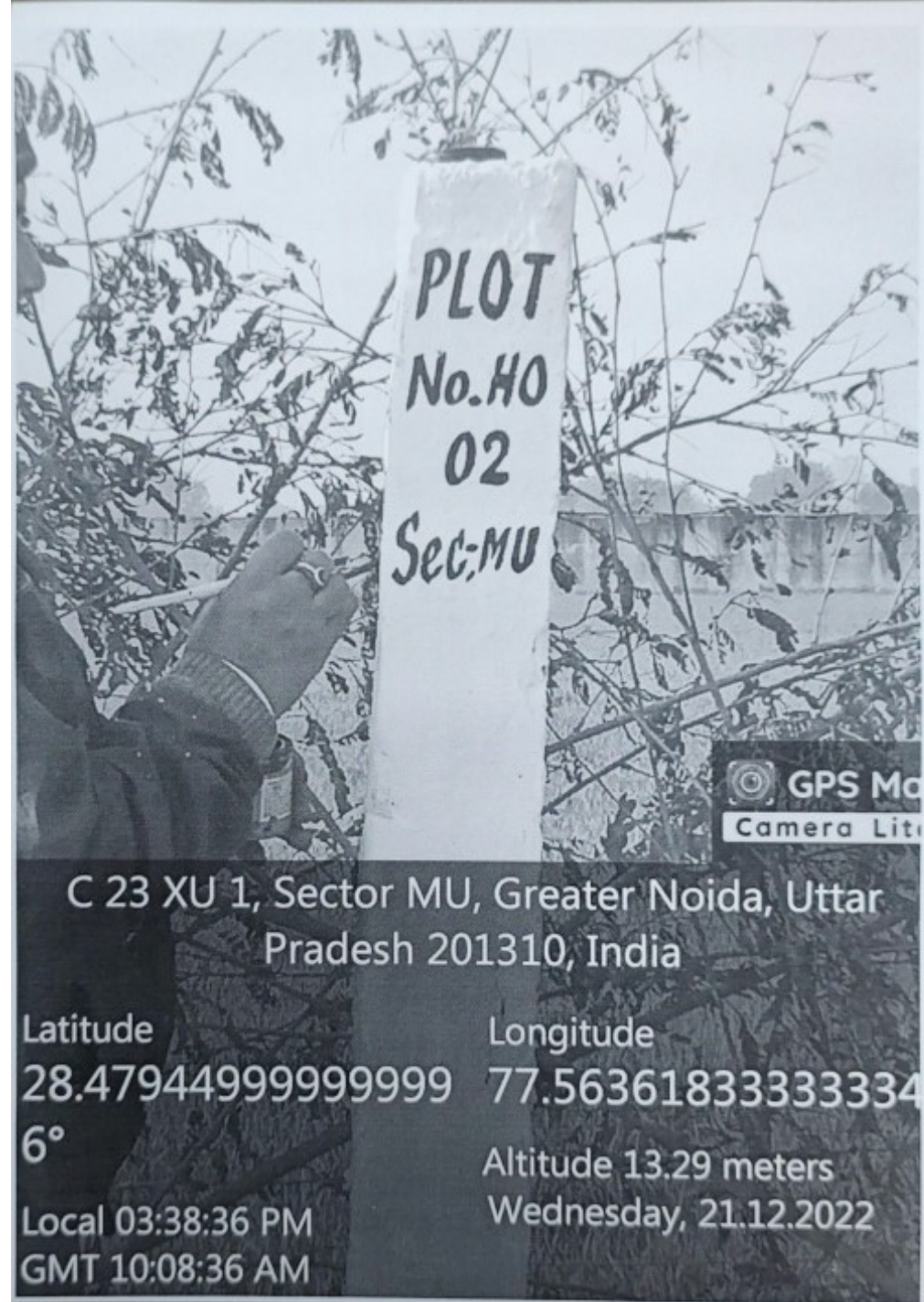
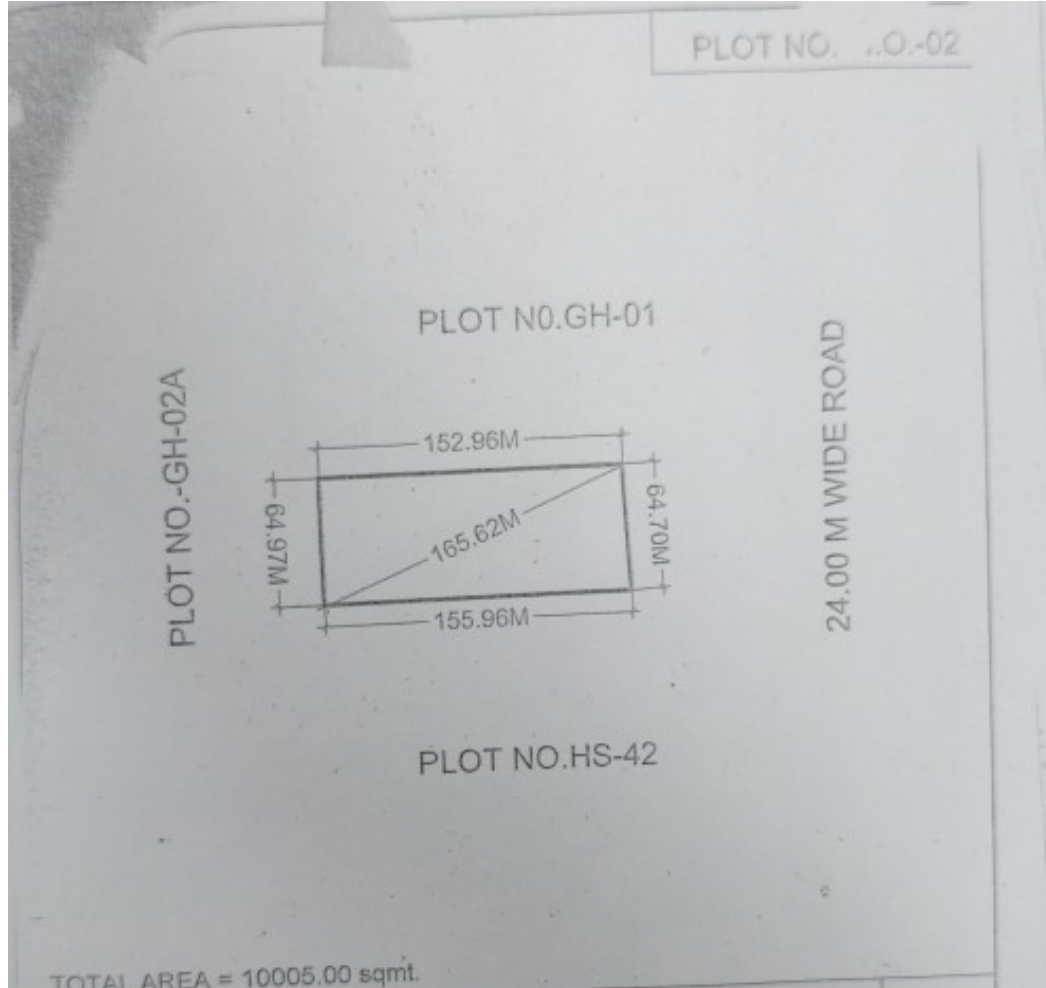



# PLOT NO – 202, KP-5

332000.00 sq.m.

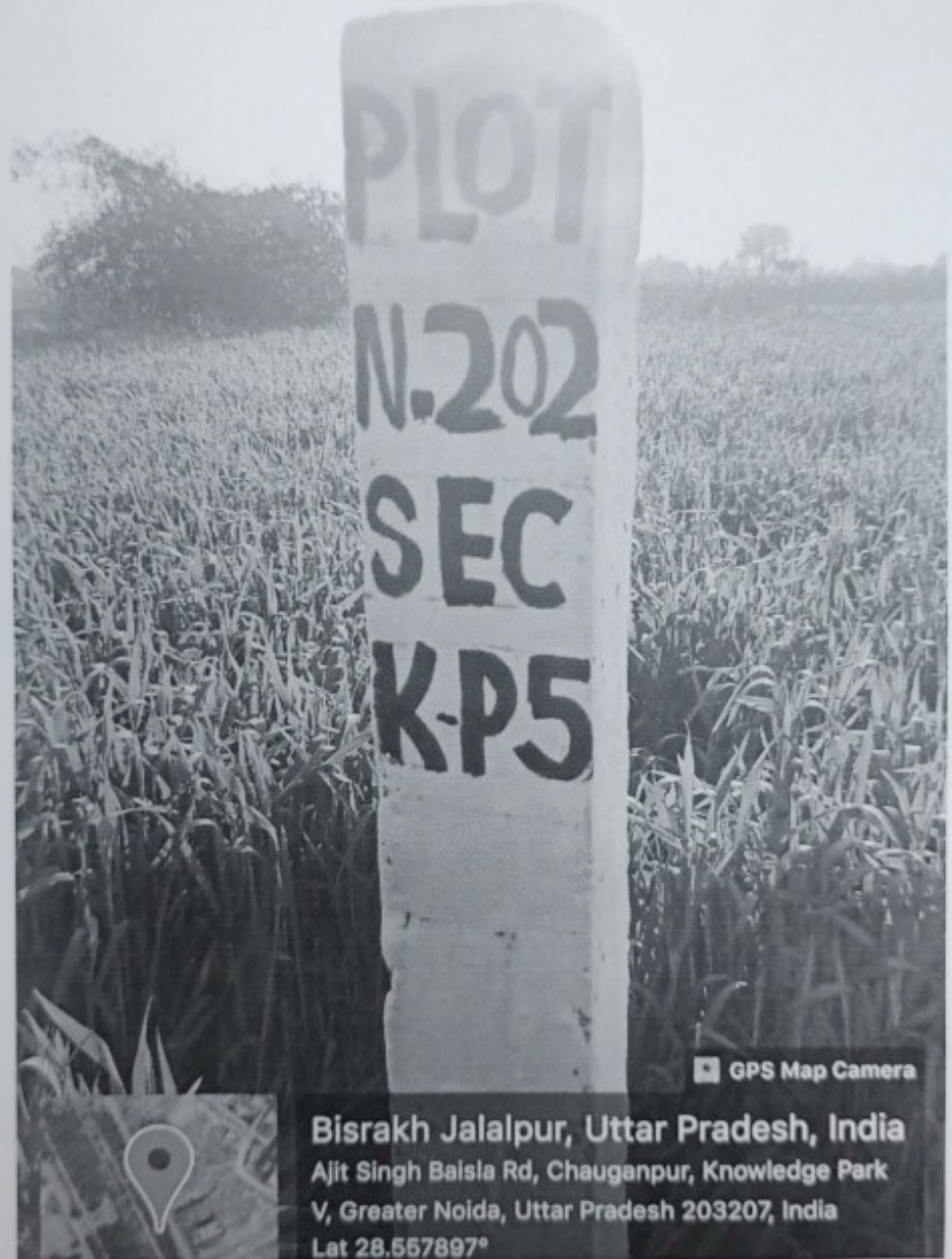
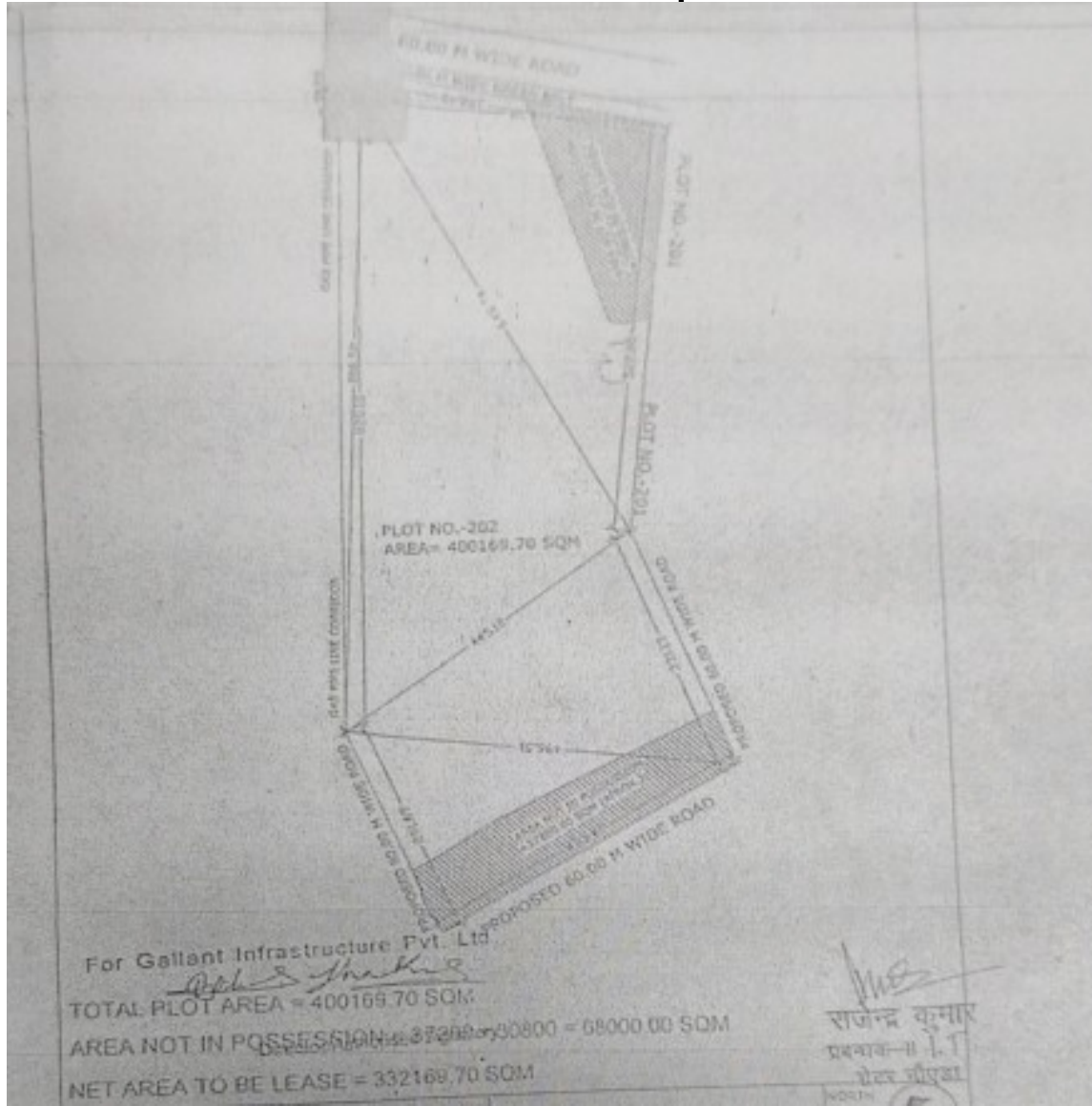



# PLOT NO – 132, KP-5

1001.25 sq.m.

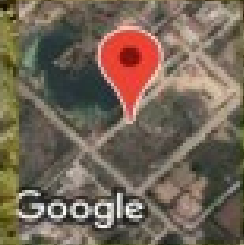
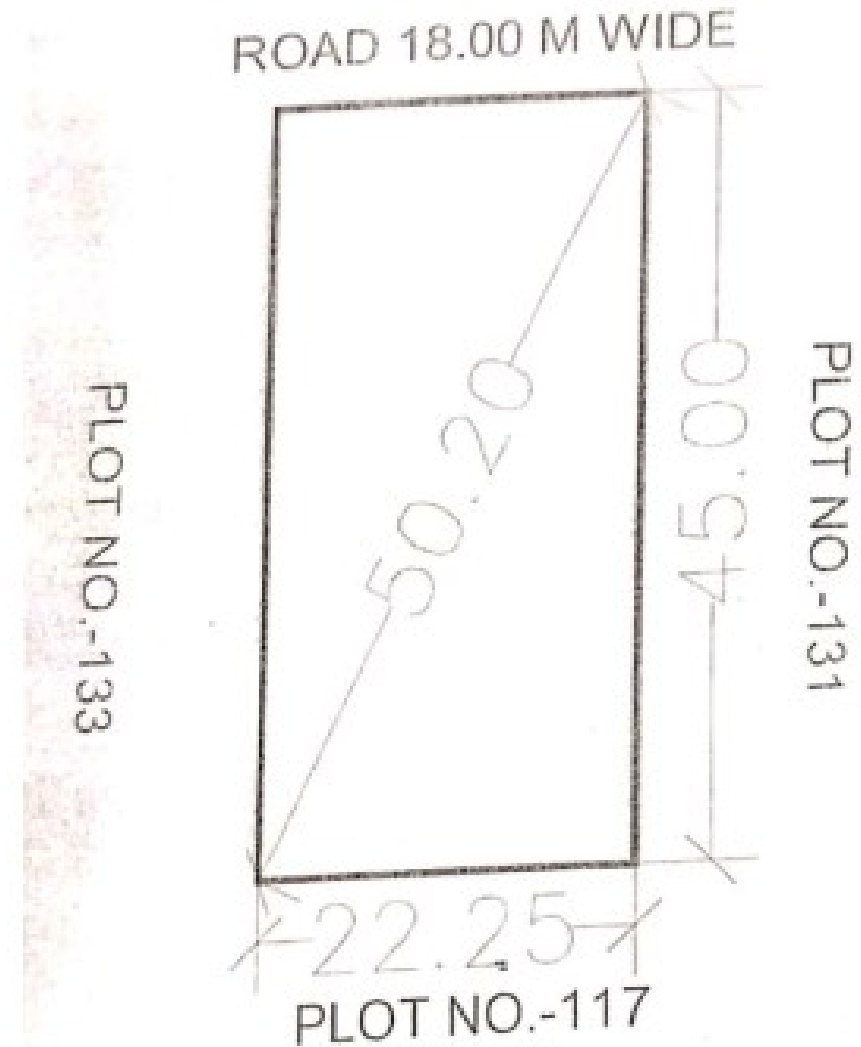

Greater Noida, Uttar Pradesh, India  
GFWF+293, Tusiana Village, Knowledge Park  
V, Greater Noida, Uttar Pradesh 201306, India  
Lat 28.544021°  
Long 77.473012°  
10/12/22 12:11 PM GMT +05:30



PLOT NO – 89, KP-5  
2,001.00 sq.m.

ROAD 18.0M WIDE

PLOT NO.-90

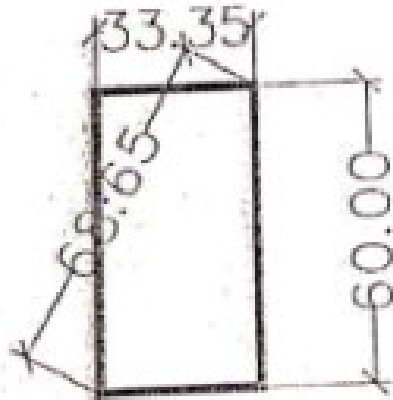

PLOT NO.-88

PLOT NO.-86

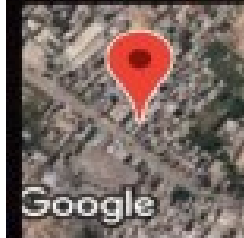

GPS Map Camera  
Greater Noida, Uttar Pradesh, India  
GF7F+GQ3, Surajpur, Greater Noida, Uttar Pradesh 201306, India  
Lat 28.513814°  
Long 77.474455°  
09/12/22 06:42 PM GMT +05:30



# PLOT NO – 12, Techzone-02

114200.00 sq.m.

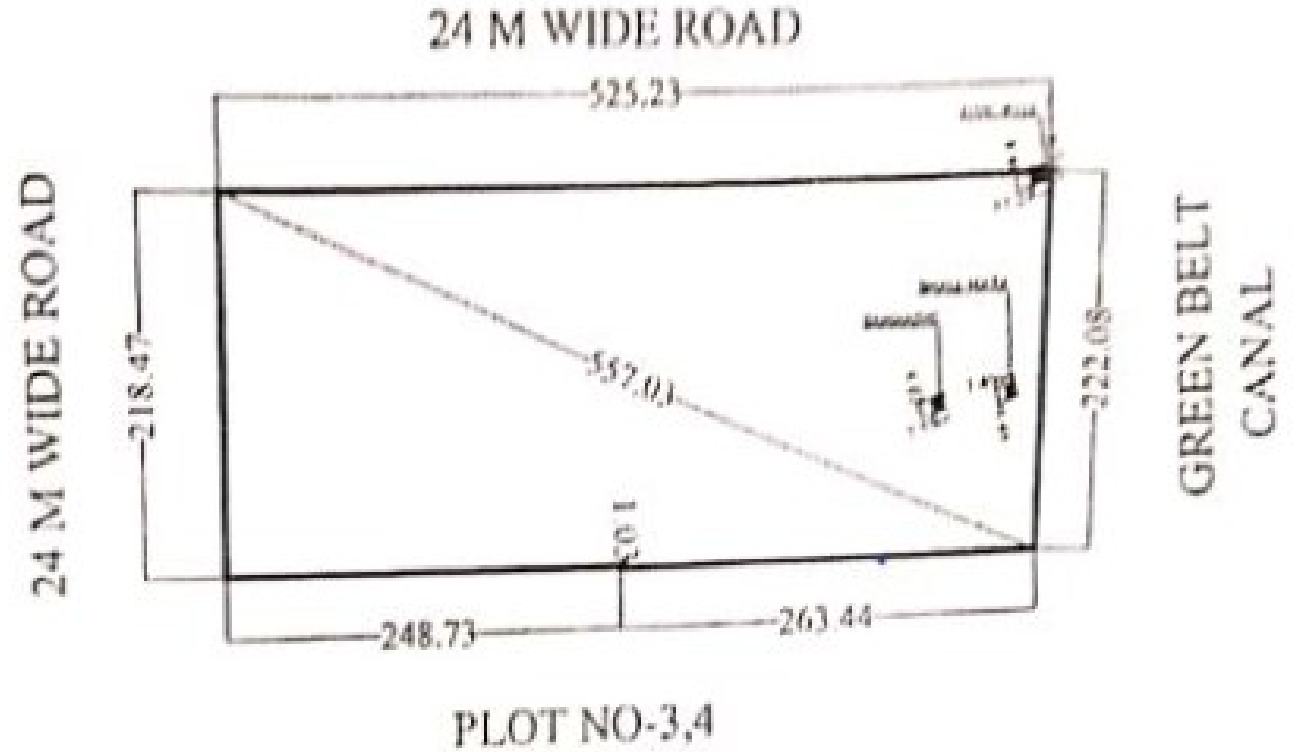
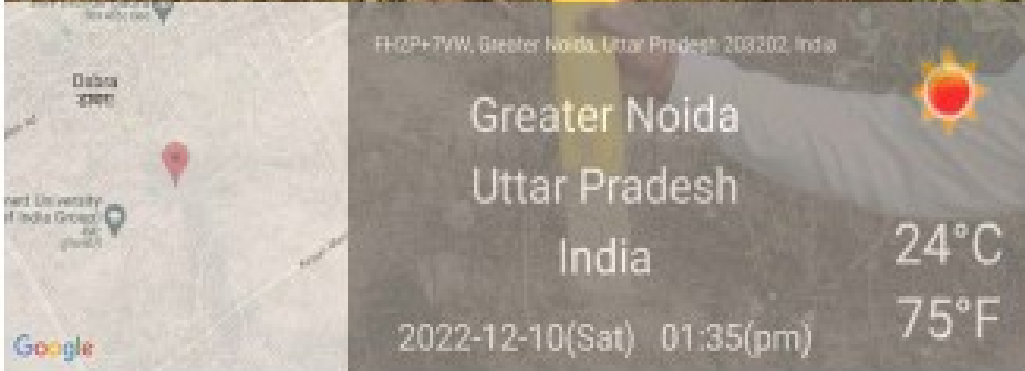



# PLOT NO – 17/2, KP-3

5,900.00 sq.m.

PLOT NO-16

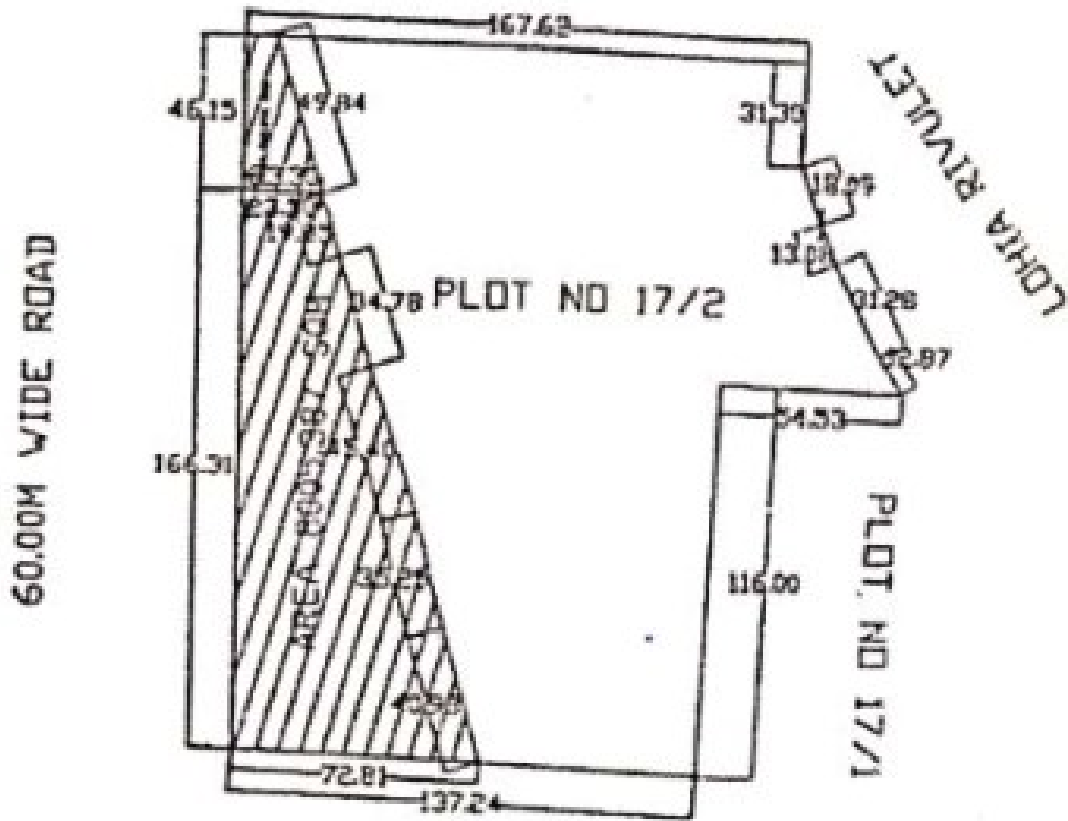

24.00M ROAD







# PLOT NO – 47, KP-5

24,224.16 sq.m.

ROAD 24.00 M WIDE

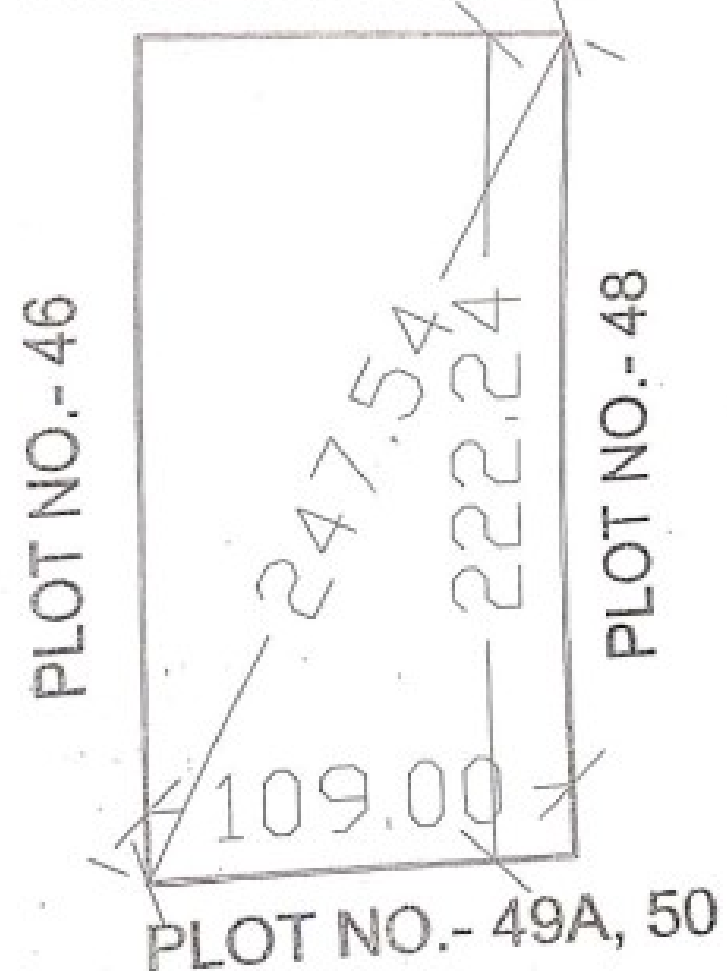

Tusyana, Uttar Pradesh, India  
C 519 Imperia residency H20, Chauganpur, Knowledge Park V,  
Tusyana, Uttar Pradesh 201306, India  
Lat 28.556128°  
Long 77.471404°  
09/12/22 04:35 PM



# PLOT NO – 33A, KP-5

20,240.00 sq.m.

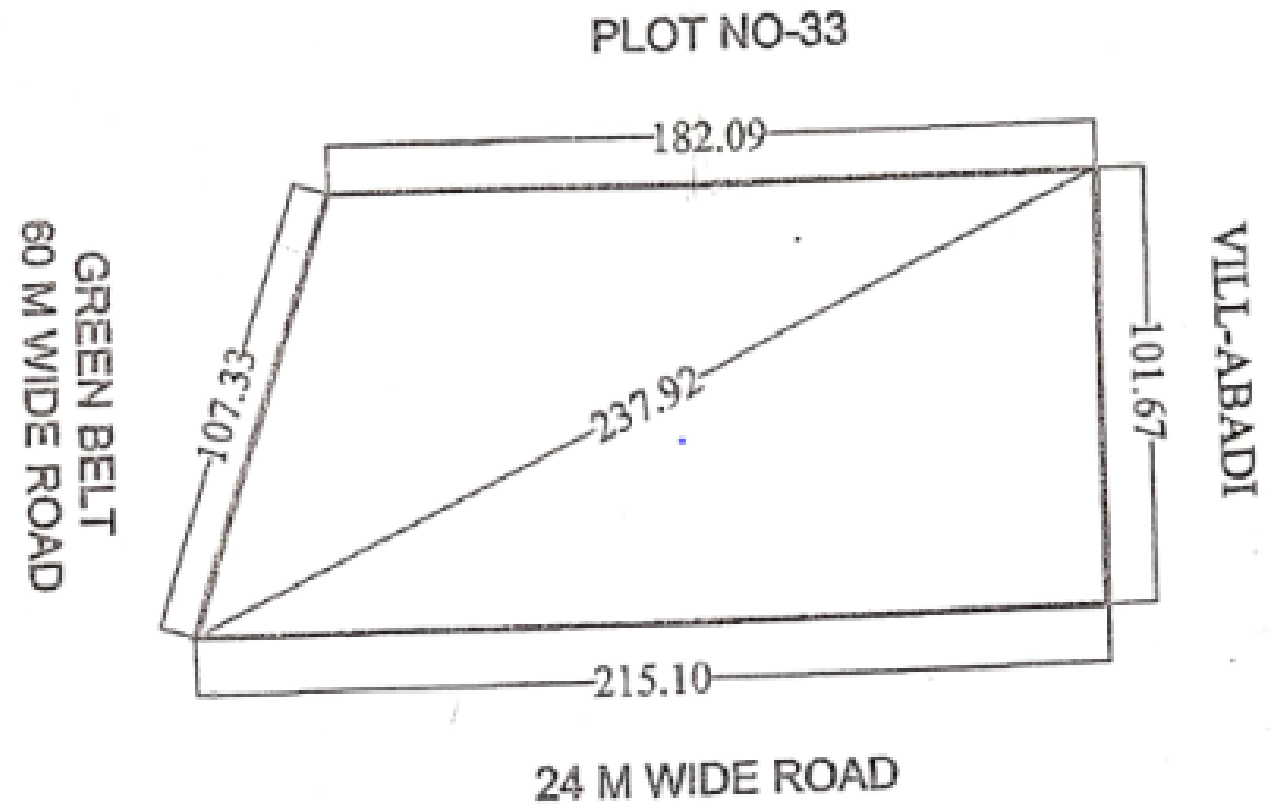



# PLOT NO – 27-E, KP-3

2,616 sq.m.

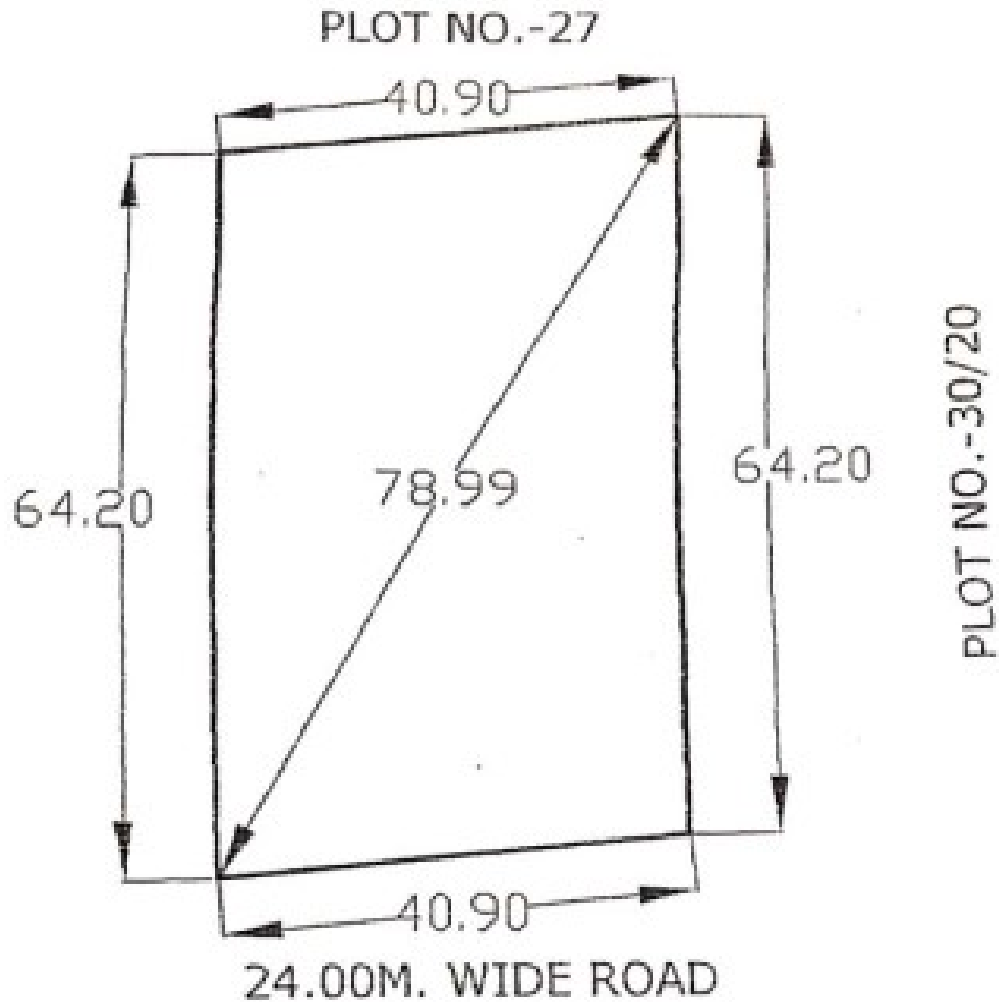



# PLOT NO – 25, techzone-4 4,000.00 sq.m.

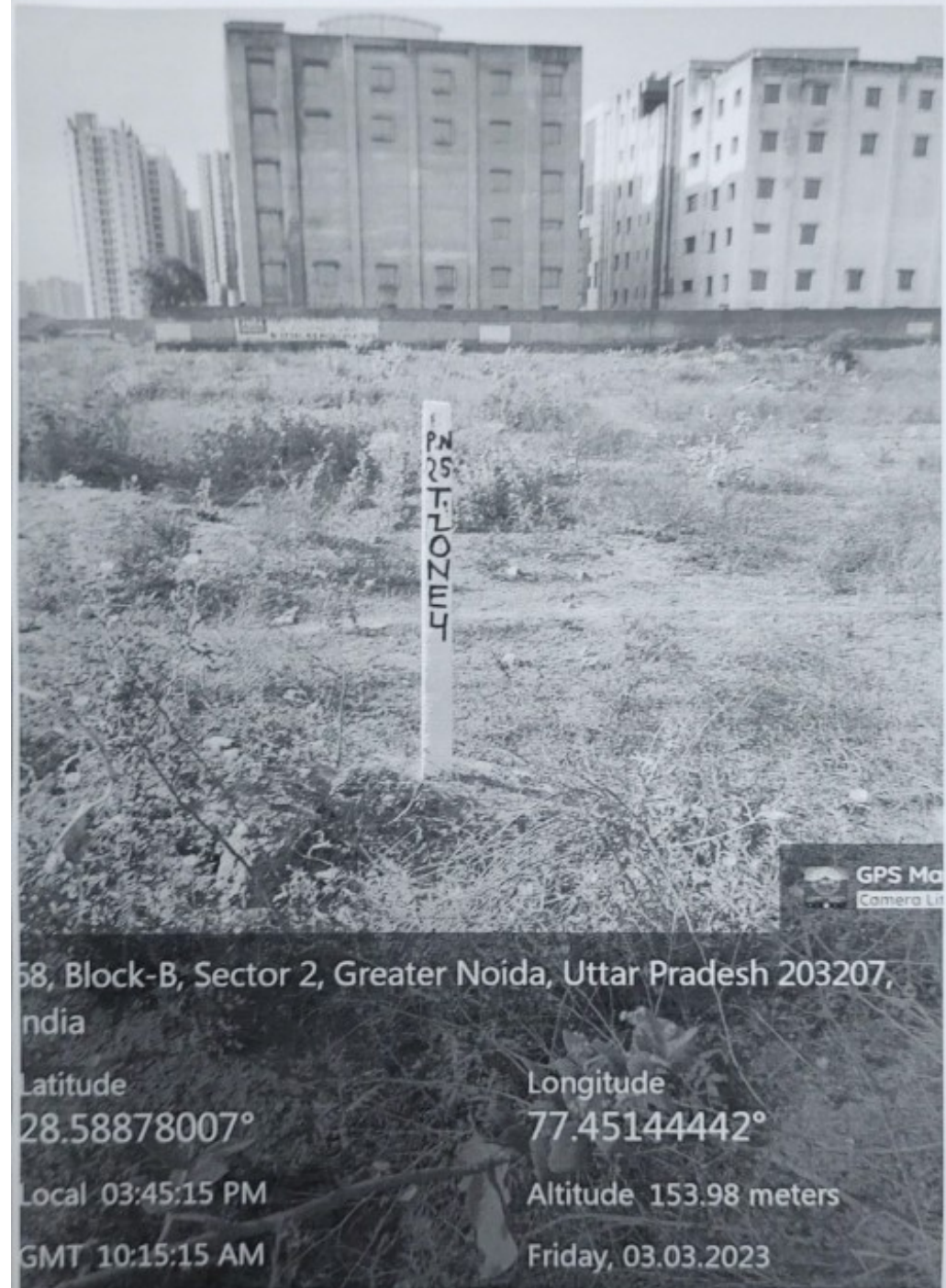
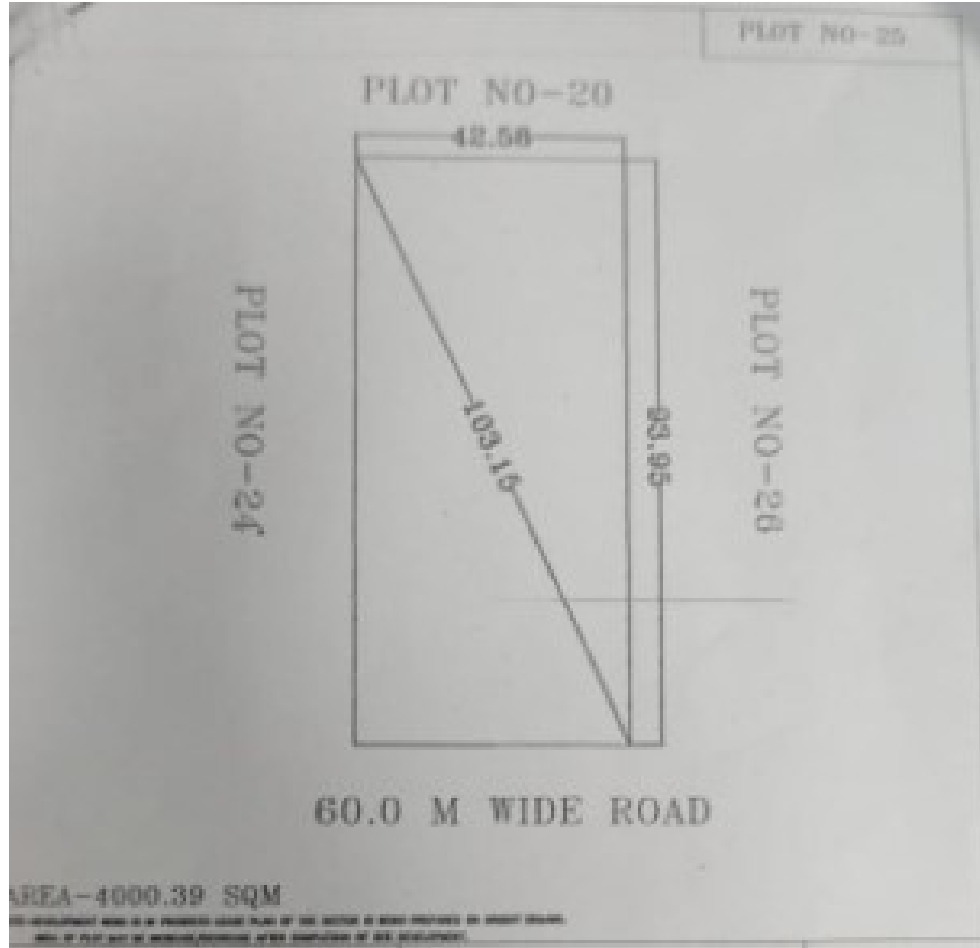



# PLOT NO – 17, Techzone-4

4,000.39 sq.m.



HFR2+PGX, JM Florence Ln, Techzone 4, Amrapali Dream Valley, Greater Noida, Uttar Pradesh 201009, India

Latitude  
28.59108125°

Longitude  
77.45202098°

Local 03:27:02 PM

Altitude 164.35 meters

GMT 09:57:02 AM

Friday, 03.03.2023

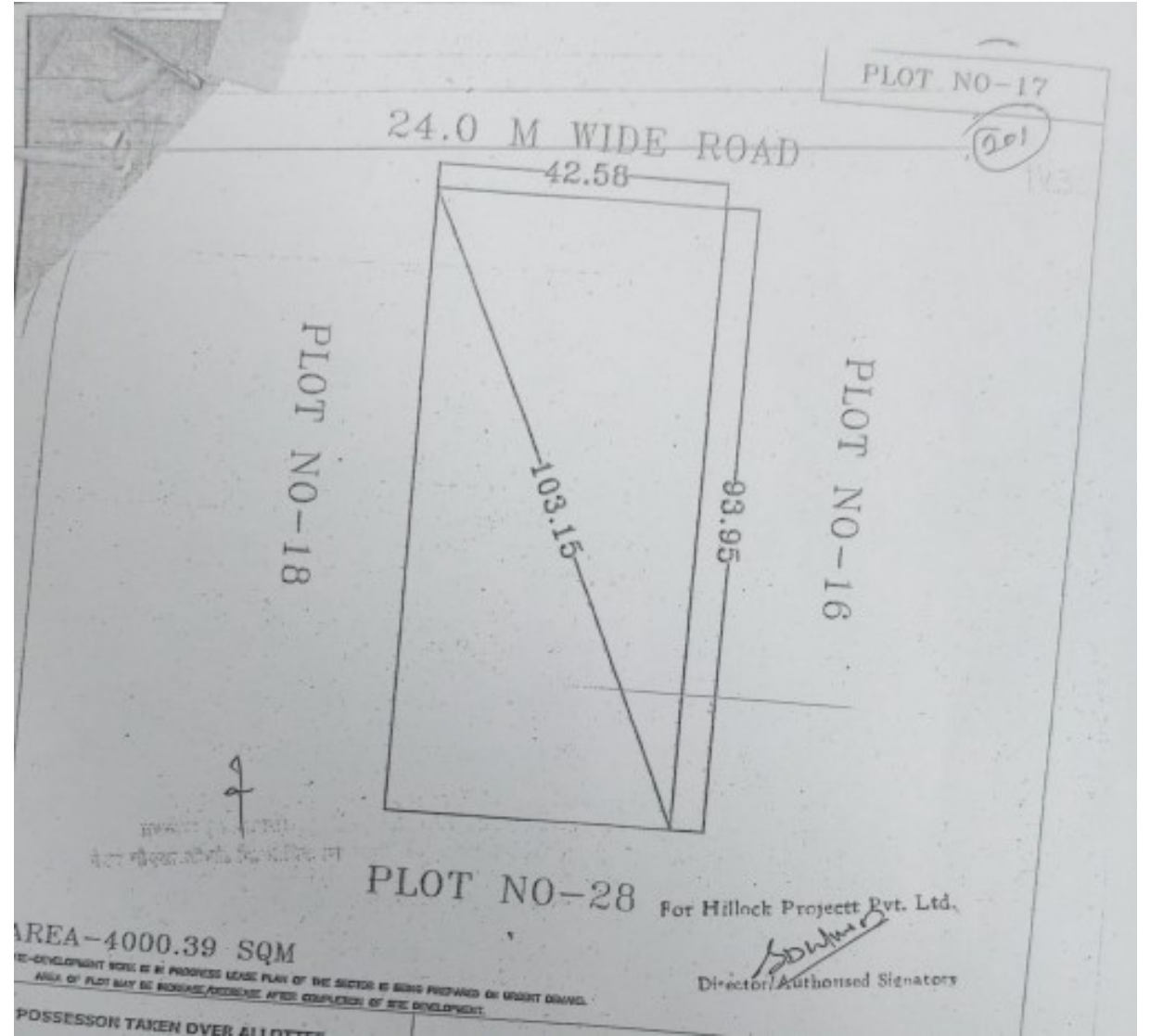



PLOT NO – 18, Techzone-4  
4,000.39 sq.m.

**PLOT  
N-18  
SECTOR  
K.P 5**

GPS Map Camera

Greater Noida, Uttar Pradesh, India

45, Chauganpur, Knowledge Park V, Greater

Noida, Uttar Pradesh 201306, India

Lat 28.55617°

Long 77.470752°

02/02/23 05:47 PM GMT +05:30



Google

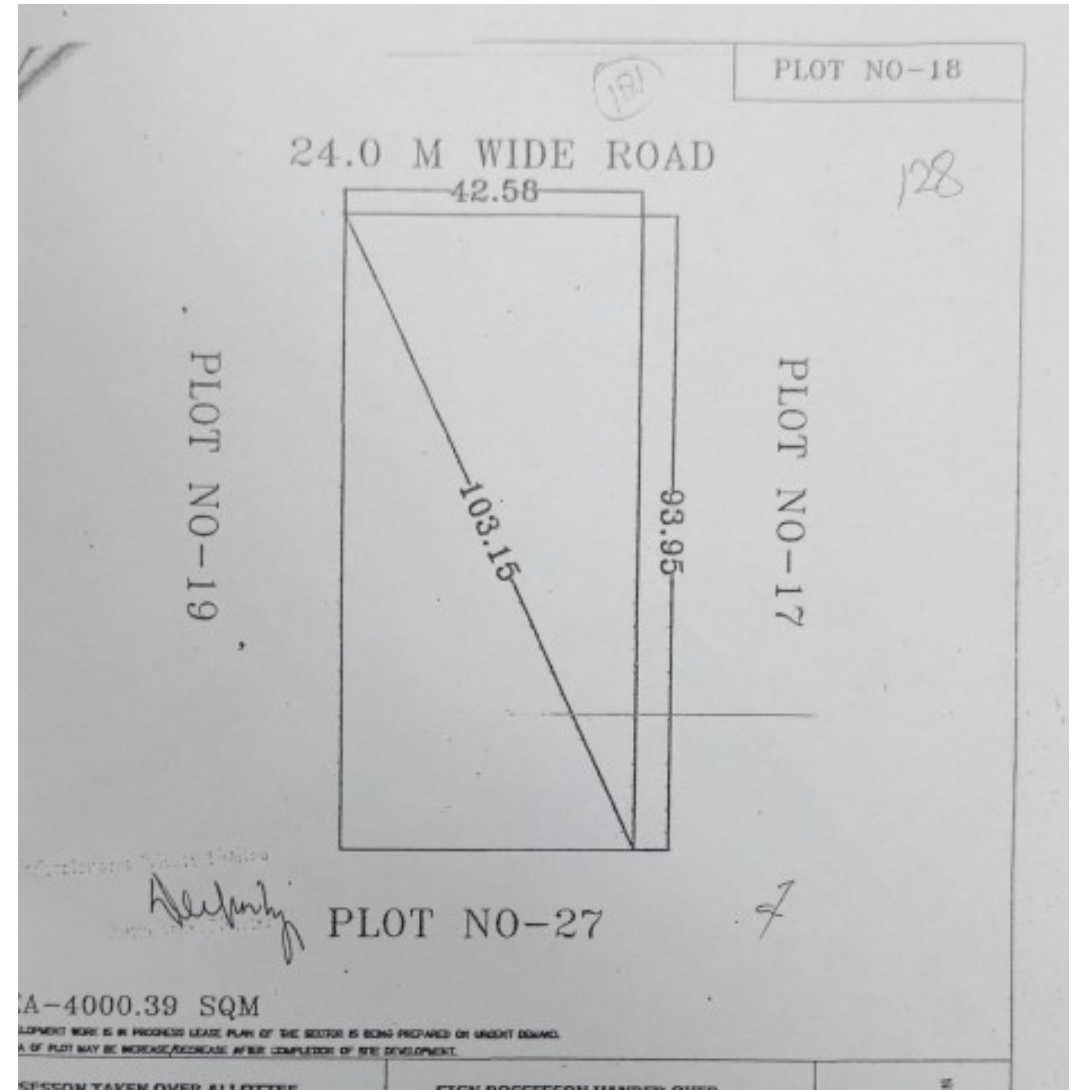



# PLOT NO – 22/3, KP-2

6,991.20 sq.m.

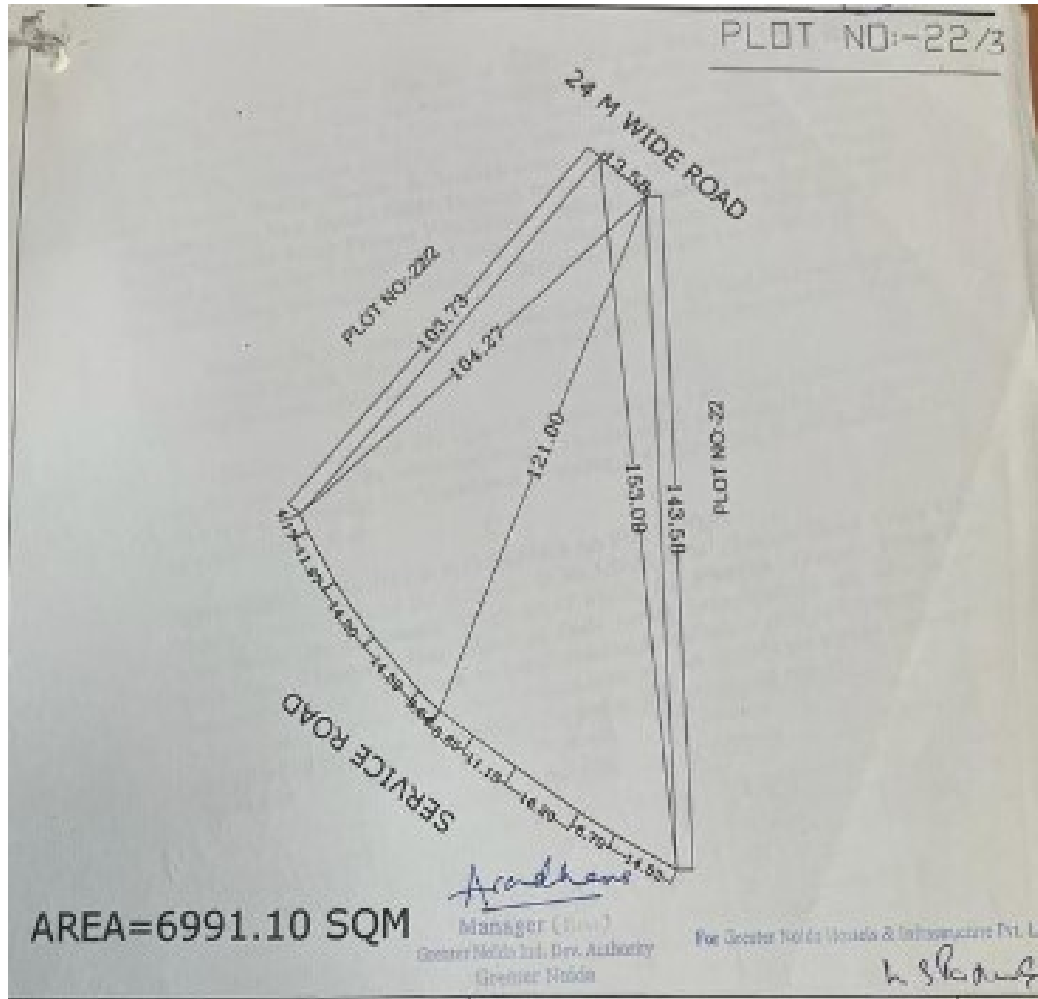

plot no -22/3

GPS Map  
Camera Lite

Gnb Residency Hostel B-Block(Girls), Gnb Residency Hostel,  
Knowledge Park II, Greater Noida, Uttar Pradesh 201310, India

Latitude

28.4693025°

Longitude

77.4953758°

Local 05:08:10 PM

GMT 11:38:10 AM

Altitude 196 meters

Monday, 20.03.2023